

Norfolk Boreas Offshore Wind Farm

Works Plan

Part 4 of 4

DCO document 2.4

Applicant: Norfolk Boreas Limited
Document Reference: 2.4
Deadline: 14

Date: August 2020
Revision: Version 4
Author: Royal HaskoningDHV

Photo: Ormonde Offshore Wind Farm

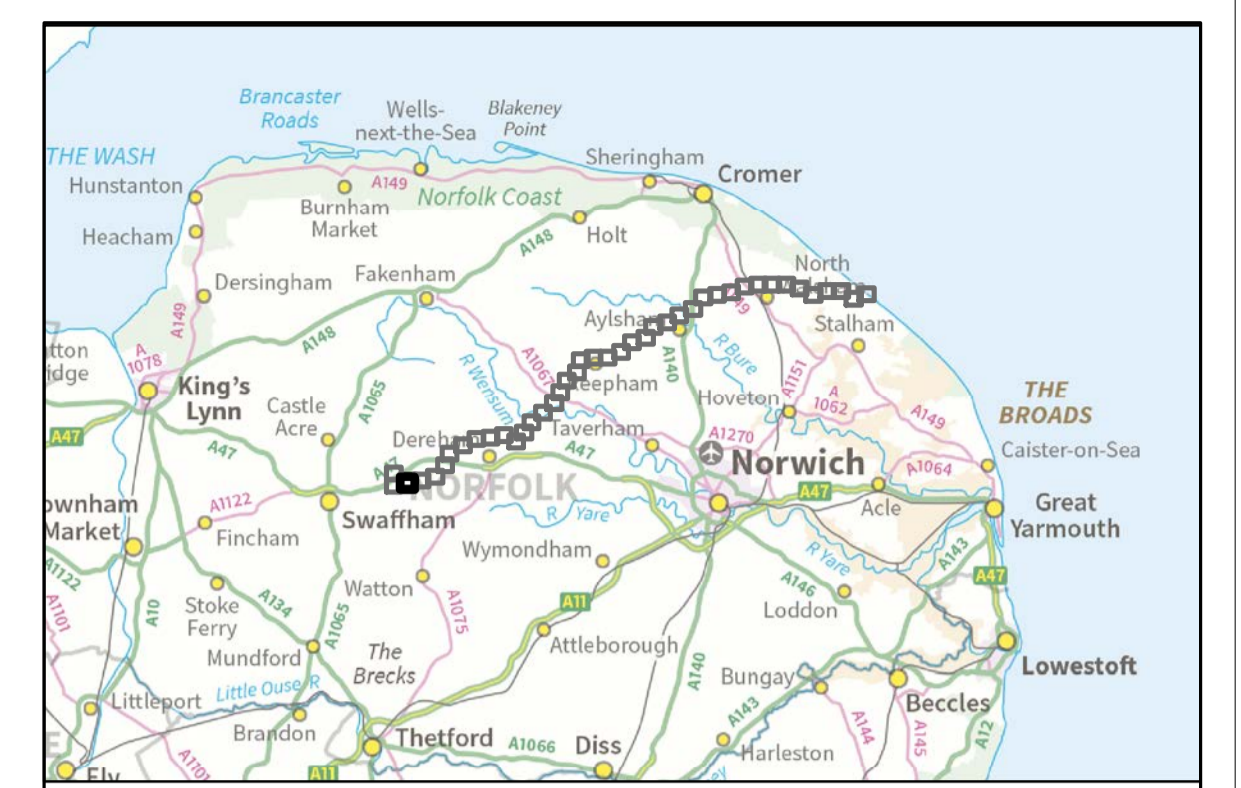
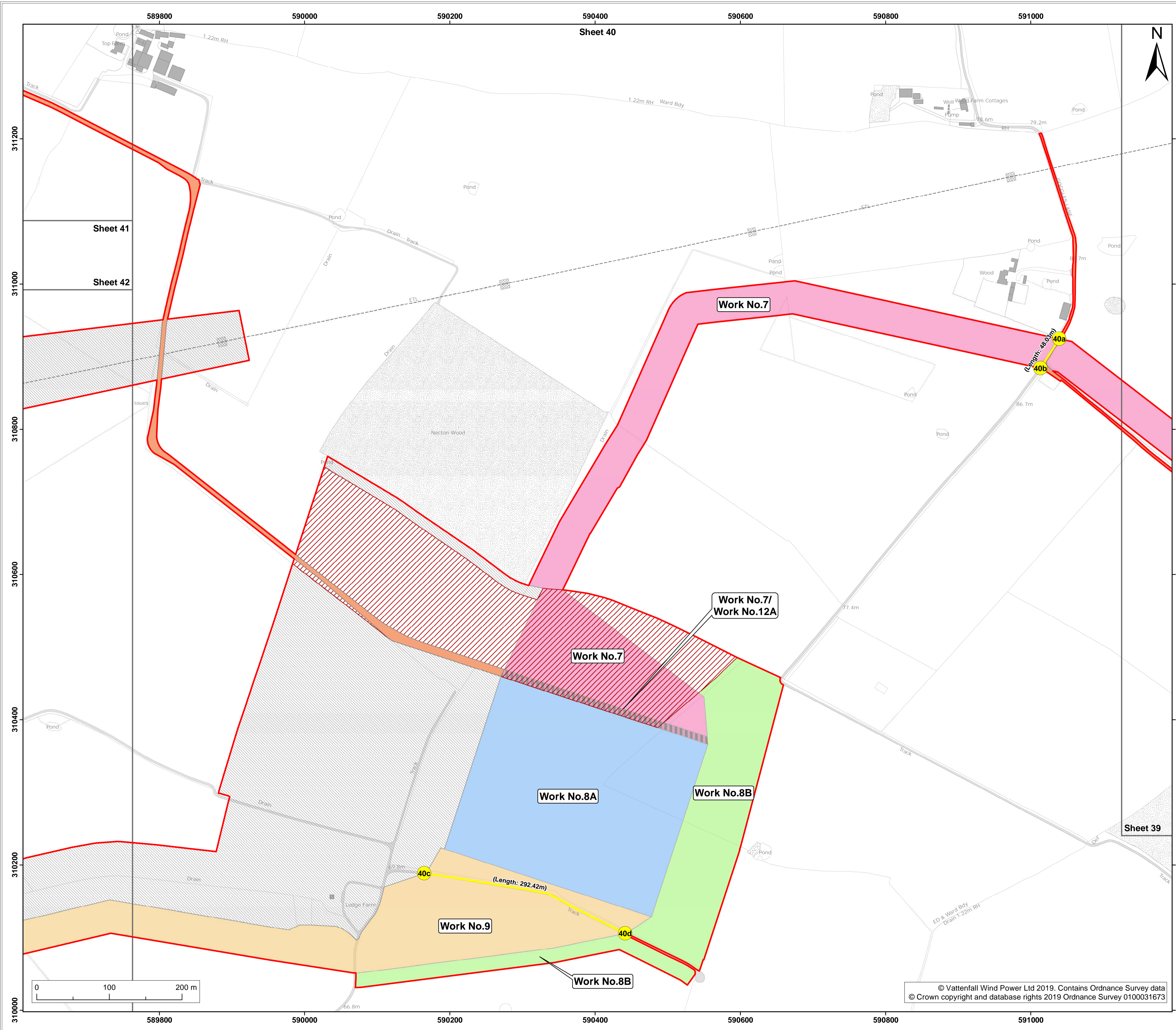

- Legend:**
- Order limits
 - Sheet boundary
 - Work No.7
 - Work No.7/Work No.12A
 - Work No.8A
 - Work No.8B
 - Work No.9
 - Alternate area only to be used under Scenario 2
- Land to be used in connection with construction or maintenance of the works**
- Temporary construction area
 - Site side access
 - Street subject to street works (private tracks)
 - Points referred to in Schedule 2 of the DCO

Project: **Norfolk Boreas Offshore Wind Farm** Report: **Development Consent Order**

Title: **2.4 Works plan (onshore) (sheet 40a of 42 - Scenario 1)**

Doc Ref: 2.4	APFP Ref: 5(2)(j)	Drawing No: PB5640-007-000-007			
Revision: 03	Date: 19/02/2019	Drawn: LB	Checked: CD	Size: A1	Scale: 1:2,500
Revision: 02	Date: 02/01/2019	Drawn: LB	Checked: CD	Size: A1	Scale: 1:2,500

Co-ordinate system: British National Grid EPSG: 27700

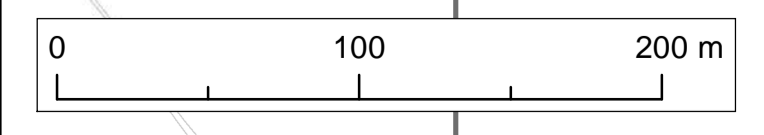

© Vattenfall Wind Power Ltd 2019. Contains Ordnance Survey data © Crown copyright and database rights 2019 Ordnance Survey 0100031673



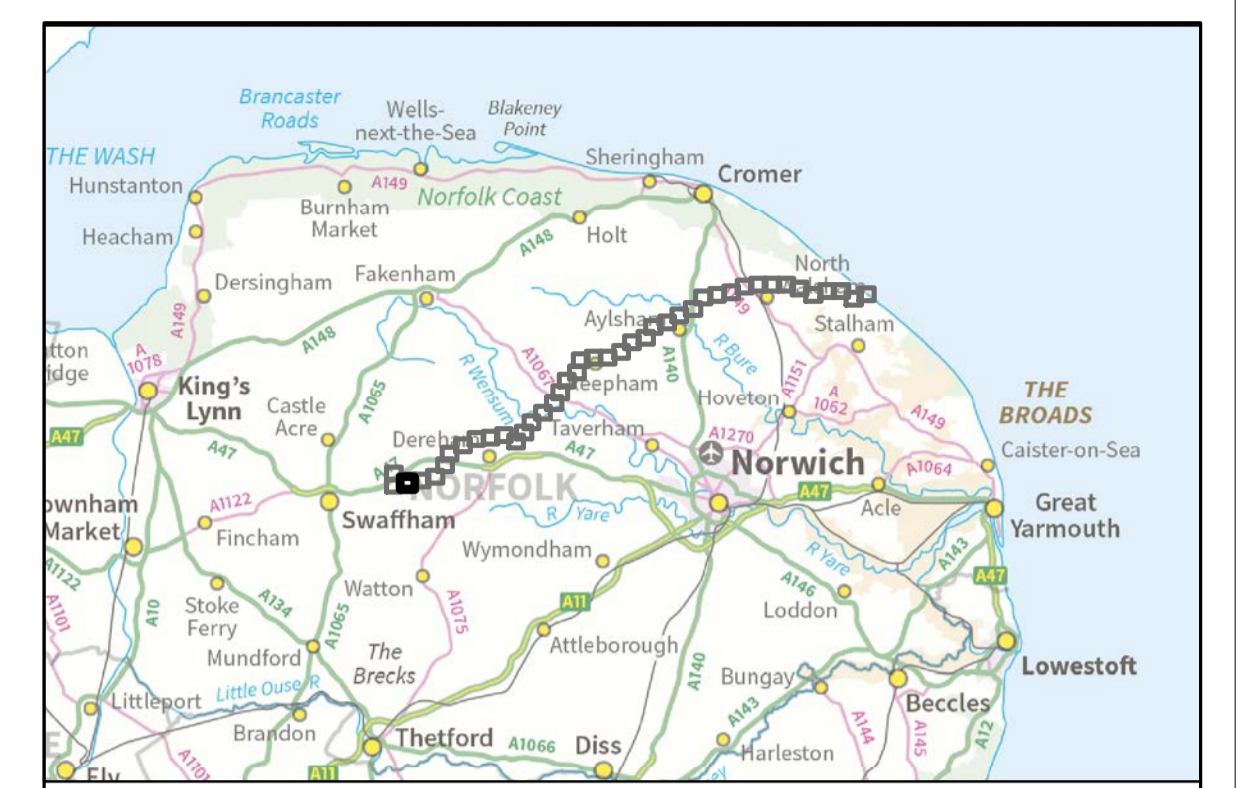
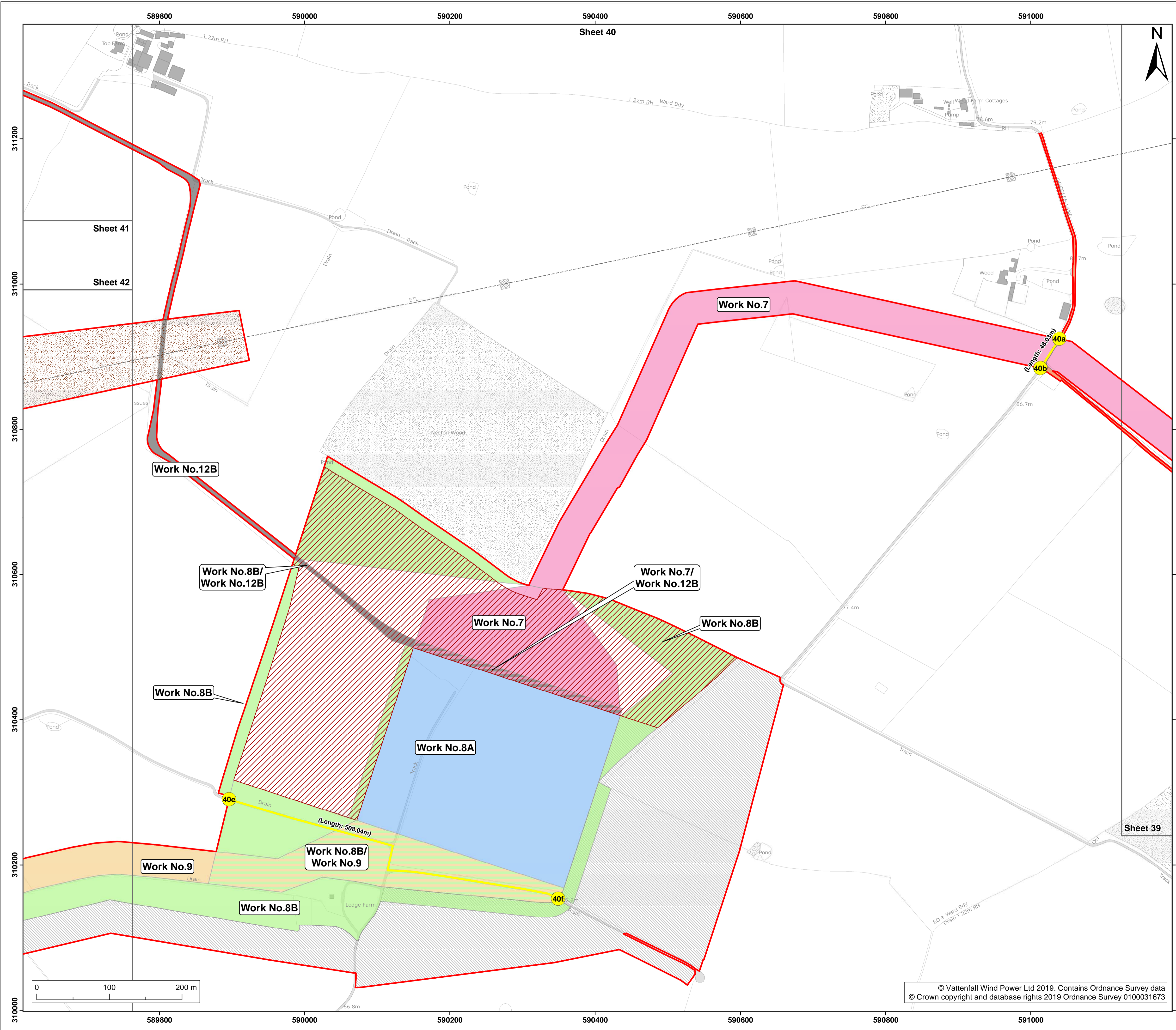

- Legend:**
- Order limits
 - Sheet boundary
 - Work No.7
 - Work No.7/Work No.12B
 - Work No.8A
 - Work No.8B
 - Work No.8B/Work No.9
 - Work No.9
 - Work No.12B
 - Alternate area only to be used under Scenario 1
- Land to be used in connection with construction or maintenance of the works**
- Temporary construction area
 - National Grid overhead line temporary works area and overhead line modification corridor
 - Site side access
 - Street subject to street works (private tracks)
 - Points referred to in Schedule 2 of the DCO

Project: **Norfolk Boreas Offshore Wind Farm** Report: **Development Consent Order**

Title: **2.4 Works plan (onshore) (sheet 40b of 42 - Scenario 2)**

Doc Ref: 2.4	APFP Ref: 5(2)(j)	Drawing No: PB5640-007-000-008			
Revision: 04	Date: 04/03/2019	Drawn: LB	Checked: CD	Size: A1	Scale: 1:2,500
Revision: 03	Date: 19/02/2019	Drawn: LB	Checked: CD	Size: A1	Scale: 1:2,500

Co-ordinate system: British National Grid EPSG: 27700



© Vattenfall Wind Power Ltd 2019. Contains Ordnance Survey data © Crown copyright and database rights 2019 Ordnance Survey 0100031673

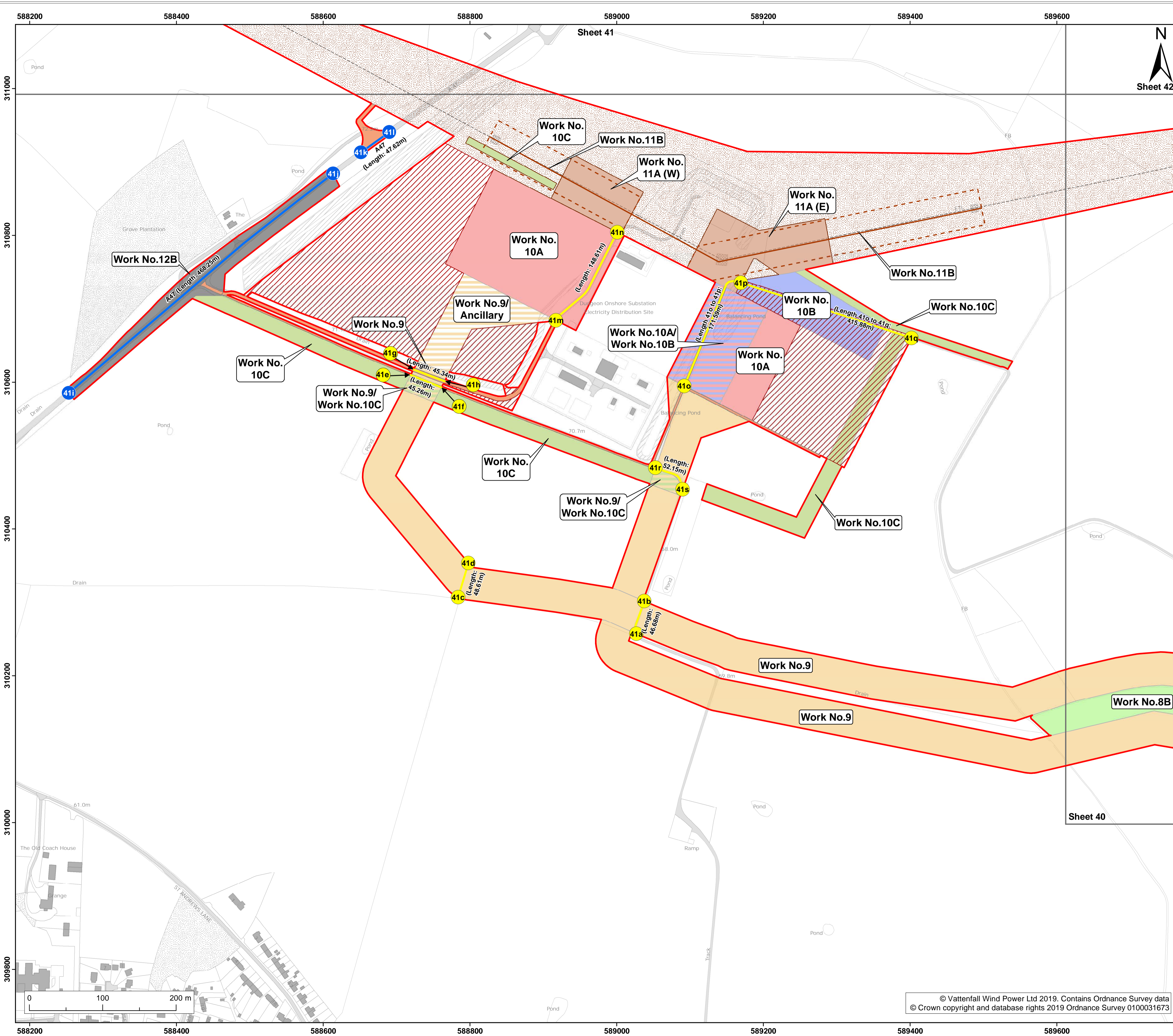

Legend:

- Order limits
- Sheet boundary
- Work No.8B
- Work No.9
- Work No.9/Ancillary
- Work No.9/Work No.10C
- Work No.10A
- Work No.10B
- Work No.10A/Work No.10B
- Work No.10C
- Work No.11A
- Work No. 11B
- Work No.12B

Land to be used in connection with construction or maintenance of the works

- Temporary construction area
- National Grid overhead line temporary works area and overhead line modification corridor
- National Grid overhead line limits of deviation
- Site side access

Street subject to street works (streets)

- Points referred to in Schedule 2 of the DCO
- Points referred to in Schedule 2 of the DCO

Project: **Norfolk Boreas Offshore Wind Farm** Report: **Development Consent Order**

Title: **2.4 Works plan (onshore) (sheet 41 of 42 - Combined plan for Scenario 1 and Scenario 2)**

Doc Ref: 2.4	APFP Ref: 5(2)(j)	Drawing No: PB5640-007-000-006			
Revision: 06	Date: 13/03/2019	Drawn: LB	Checked: CD	Size: A1	Scale: 1:2,500
Revision: 05	Date: 04/03/2019	Drawn: LB	Checked: CD	Size: A1	Scale: 1:2,500

Co-ordinate system: British National Grid EPSG: 27700



© Vattenfall Wind Power Ltd 2019. Contains Ordnance Survey data © Crown copyright and database rights 2019 Ordnance Survey 0100031673

588200 588400 588600 588800 589000 589200 589400 589600

Sheet 41

Sheet 42

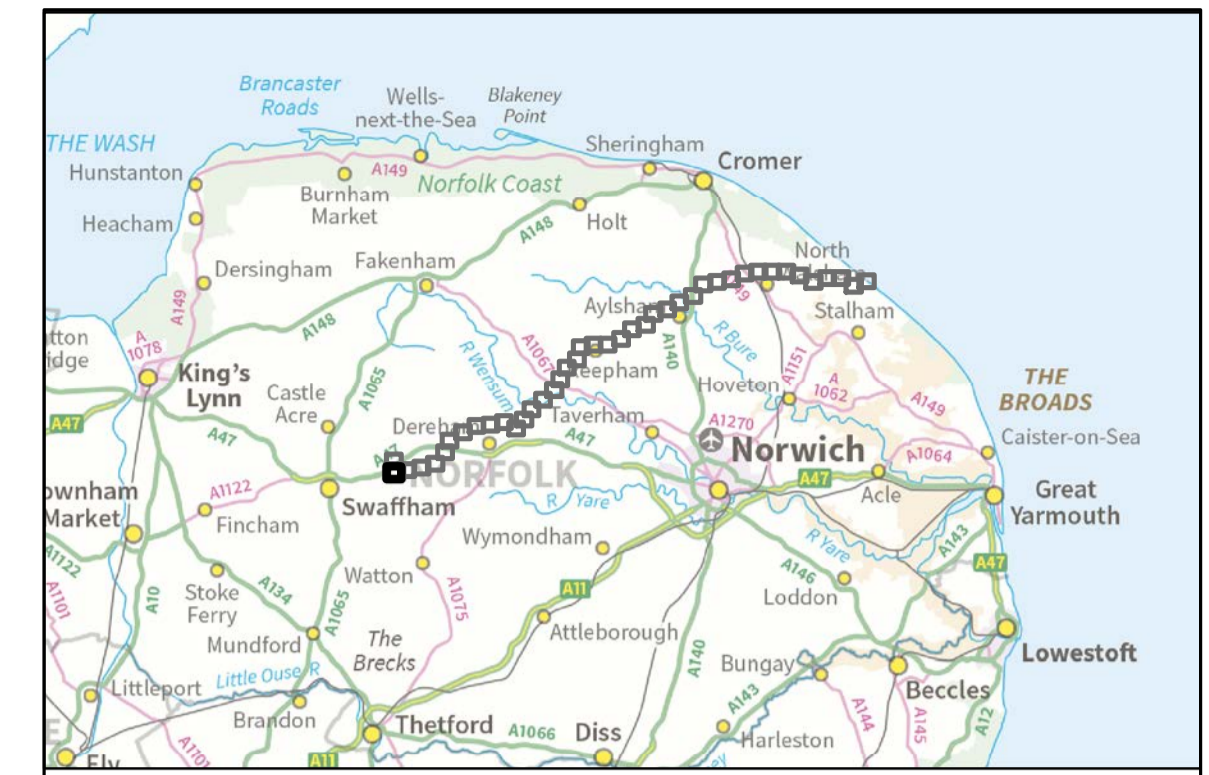
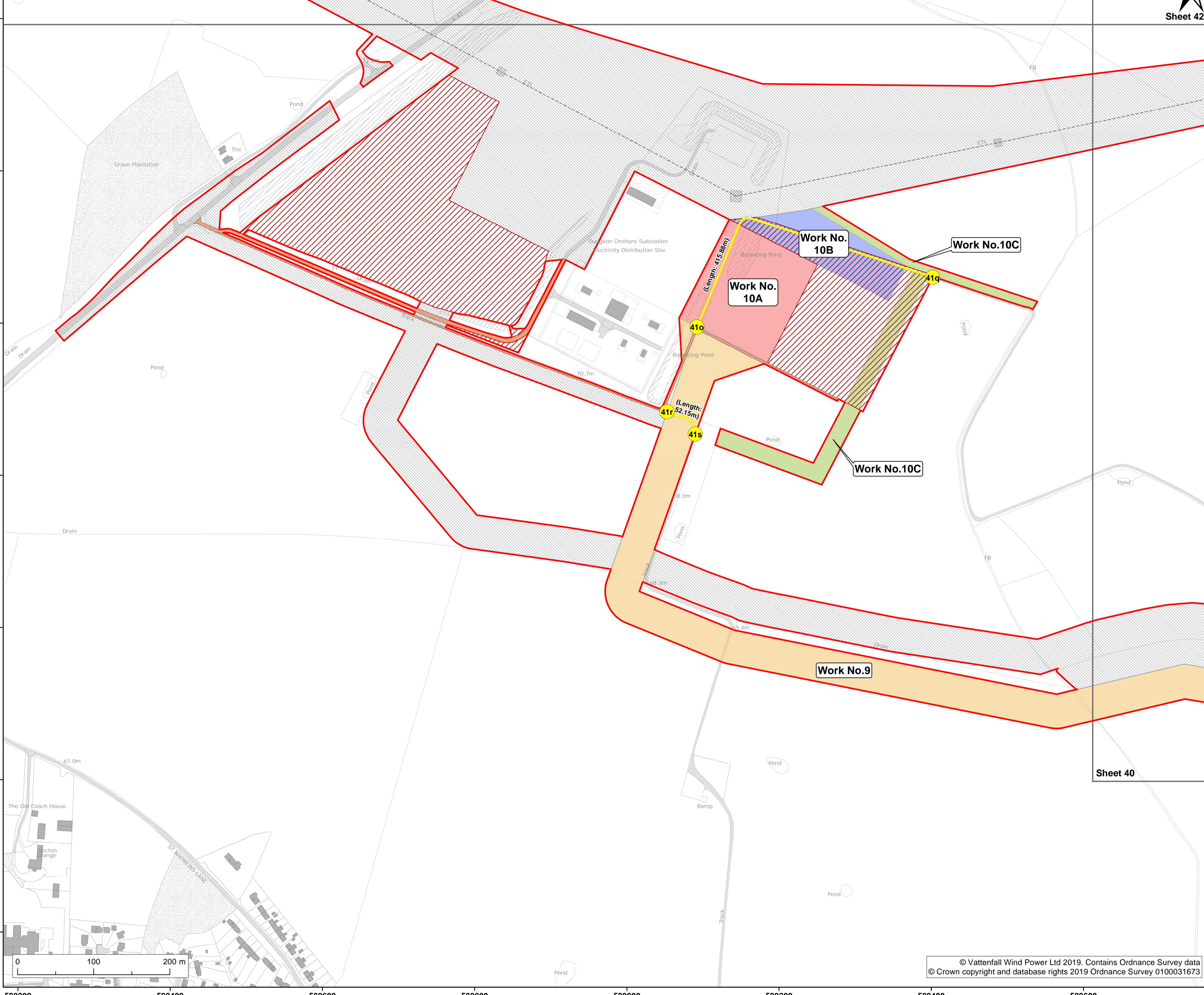

- Legend:**
- Order limits
 - Sheet boundary
 - Work No.9
 - Work No.10A
 - Work No.10B
 - Work No.10C
 - Alternate area only to be used under Scenario 2
- Land to be used in connection with construction or maintenance of the works**
- Temporary construction area
 - Site side access
 - Street subject to street works (private tracks)
 - Points referred to in Schedule 2 of the DCO

Project: **Norfolk Boreas Offshore Wind Farm** Report: **Development Consent Order**

Title: **2.4 Works plan (onshore) (sheet 41a of 42 - Scenario 1)**

Doc Ref: 2.4	APFP Ref: 5(2)(j)	Drawing No: PB5640-007-000-006			
Revision: 05	Date: 29/04/2019	Drawn: LB	Checked: CD	Size: A1	Scale: 1:2,500
Revision: 04	Date: 19/02/2019	Drawn: LB	Checked: CD	Size: A1	Scale: 1:2,500

Co-ordinate system: British National Grid EPSG: 27700

© Vattenfall Wind Power Ltd 2019. Contains Ordnance Survey data © Crown copyright and database rights 2019 Ordnance Survey 0100031673



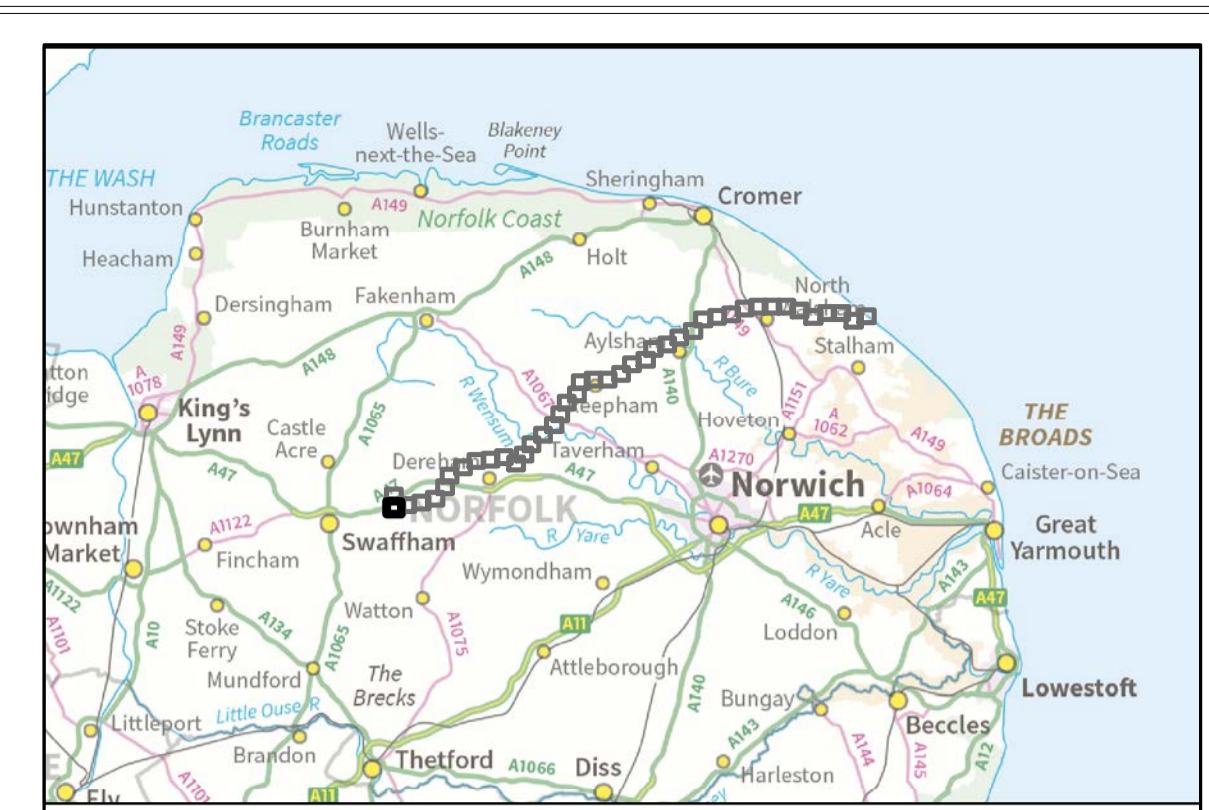
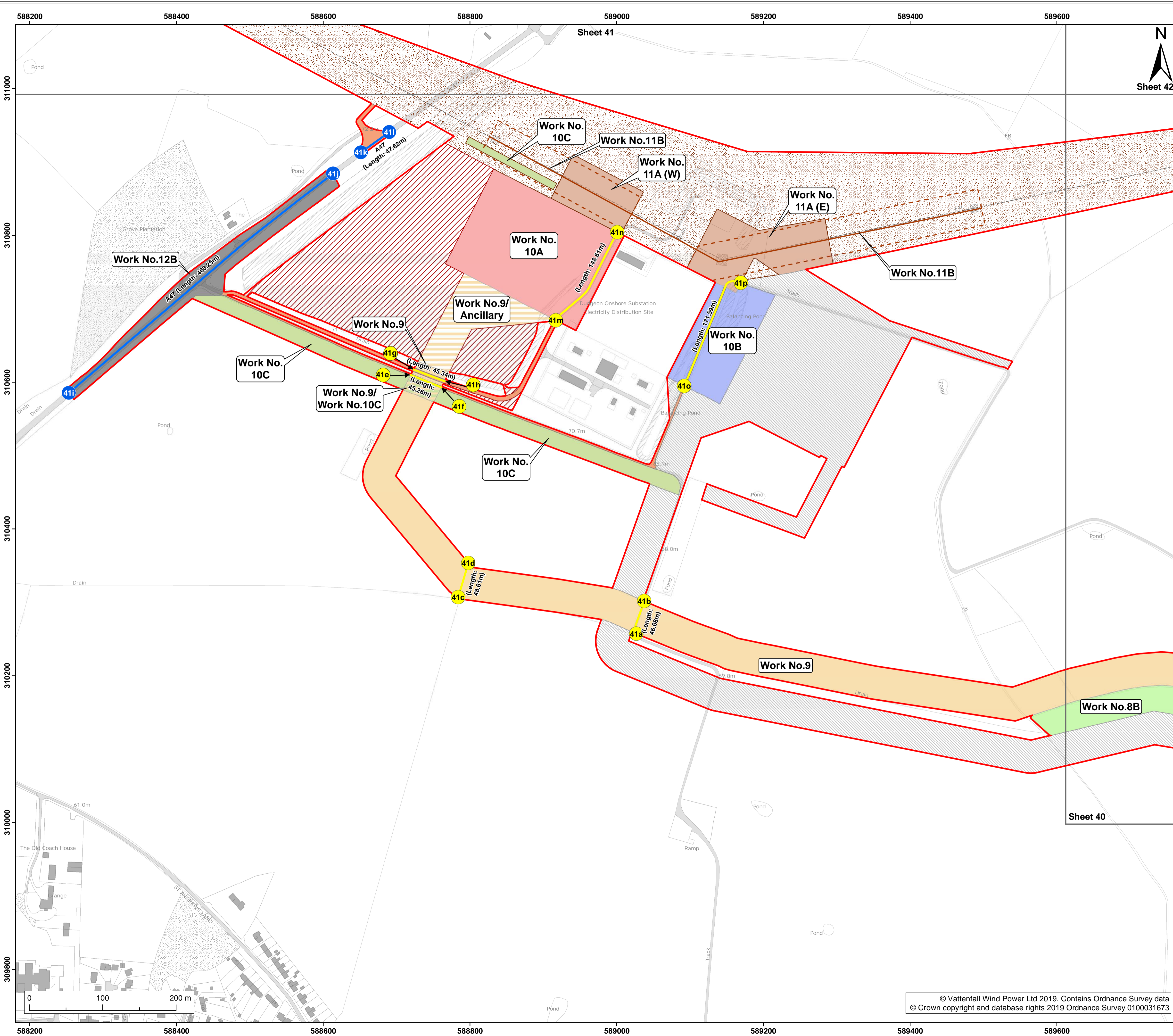

Legend:

- Order limits
- Sheet boundary
- Work No.8B
- Work No.9
- Work No.9/Ancillary
- Work No.9/Work No.10C
- Work No.10A
- Work No.10B
- Work No.10C
- Work No.11A
- Work No.11B
- Work No.12B
- Alternate area only to be used under Scenario 1

Land to be used in connection with construction or maintenance of the works

- Temporary construction area
- National Grid overhead line temporary works area and overhead line modification corridor
- National Grid overhead line limits of deviation
- Site side access
- Street subject to street works (streets)
- Points referred to in Schedule 2 of the DCO
- Street subject to street works (private tracks)
- Points referred to in Schedule 2 of the DCO

Project: **Norfolk Boreas Offshore Wind Farm** Report: **Development Consent Order**

Title: **2.4 Works plan (onshore) (sheet 41b of 42 - Scenario 2)**

Doc Ref: 2.4	APFP Ref: 5(2)(j)	Drawing No: PB5640-007-000-010			
Revision: 05	Date: 12/03/2019	Drawn: LB	Checked: CD	Size: A1	Scale: 1:2,500
Revision: 04	Date: 04/03/2019	Drawn: LB	Checked: CD	Size: A1	Scale: 1:2,500

Co-ordinate system: **British National Grid** EPSG: **27700**

© Vattenfall Wind Power Ltd 2019. Contains Ordnance Survey data © Crown copyright and database rights 2019 Ordnance Survey 0100031673



588200 588400 588600 588800 589000 589200 589400 589600

Sheet 42

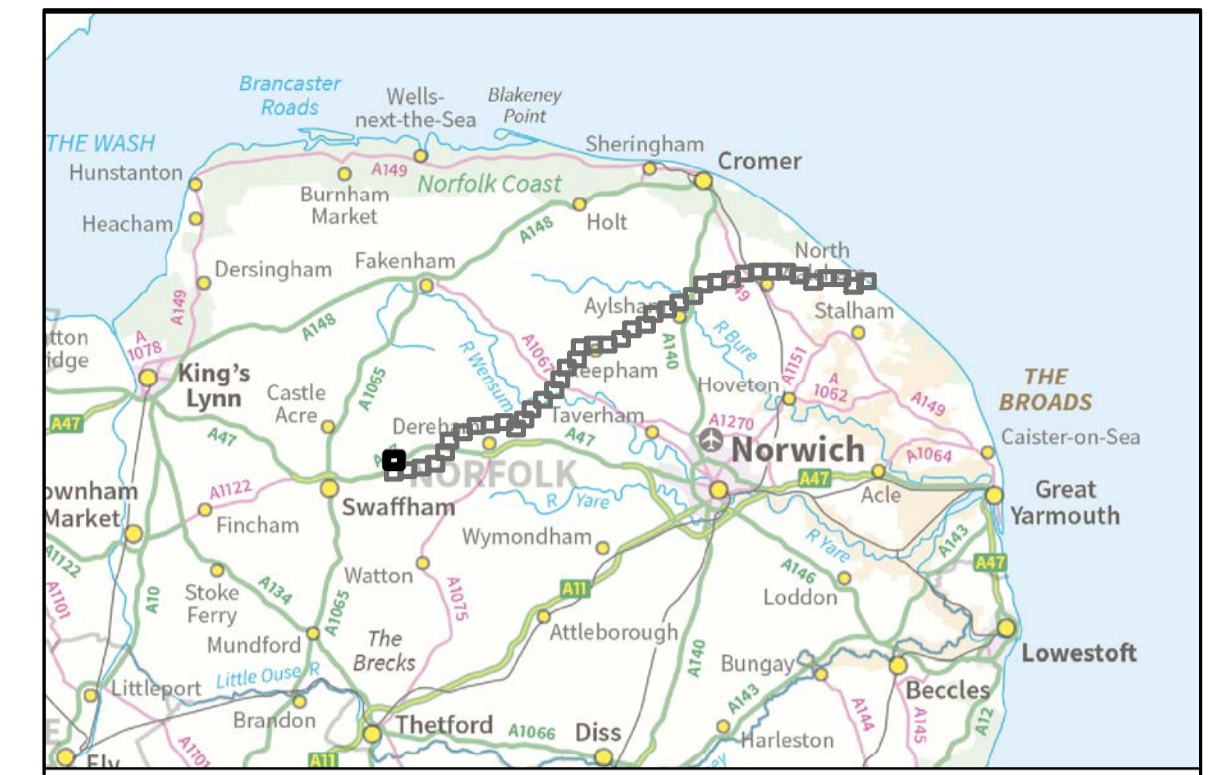
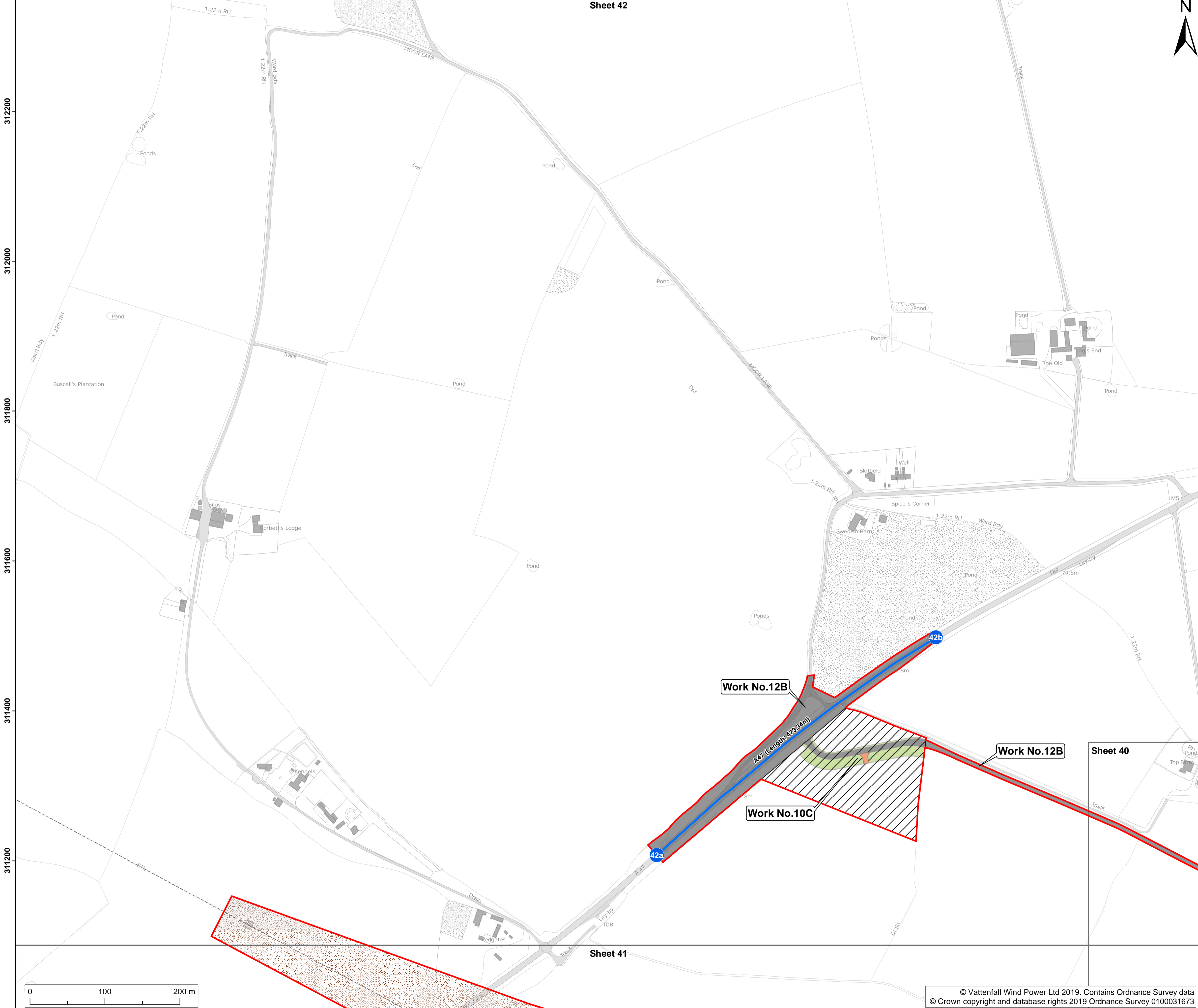

- Legend:**
- Order limits
 - Sheet boundary
 - Work No.10C
 - Work No.12B
- Land to be used in connection with construction or maintenance of the works**
- Mobilisation zone
 - National Grid overhead line temporary works area and overhead line modification corridor
 - Site side access
 - Street subject to street works (streets)
 - Points referred to in Schedule 2 of the DCO

Project: **Norfolk Boreas Offshore Wind Farm** Report: **Development Consent Order**

Title: **2.4 Works plan (onshore) (sheet 42 of 42 - Combined plan for Scenario 1 and Scenario 2)**

Doc Ref: 2.4	APFP Ref: 5(2)(j)	Drawing No: PB5640-007-000-006			
Revision: 04	Date: 19/02/2019	Drawn: LB	Checked: CD	Size: A1	Scale: 1:2,500
Revision: 03	Date: 09/01/2019	Drawn: LB	Checked: CD	Size: A1	Scale: 1:2,500

Co-ordinate system: British National Grid EPSG: 27700

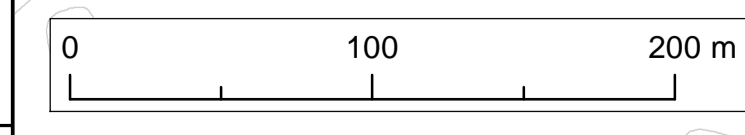

© Vattenfall Wind Power Ltd 2019. Contains Ordnance Survey data © Crown copyright and database rights 2019 Ordnance Survey 0100031673



588200 588400 588600 588800 589000 589200 589400 589600

311000

588200 588400 588600 588800 589000 589200 589400 589600

Sheet 42

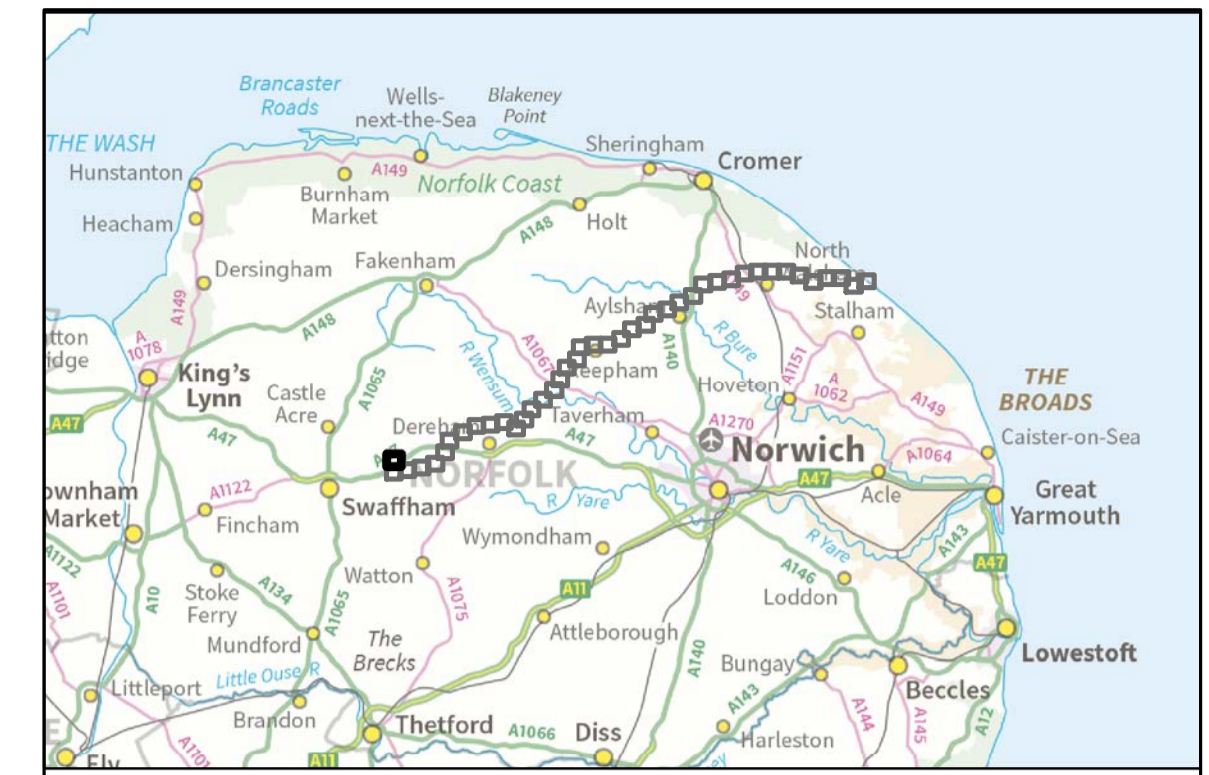
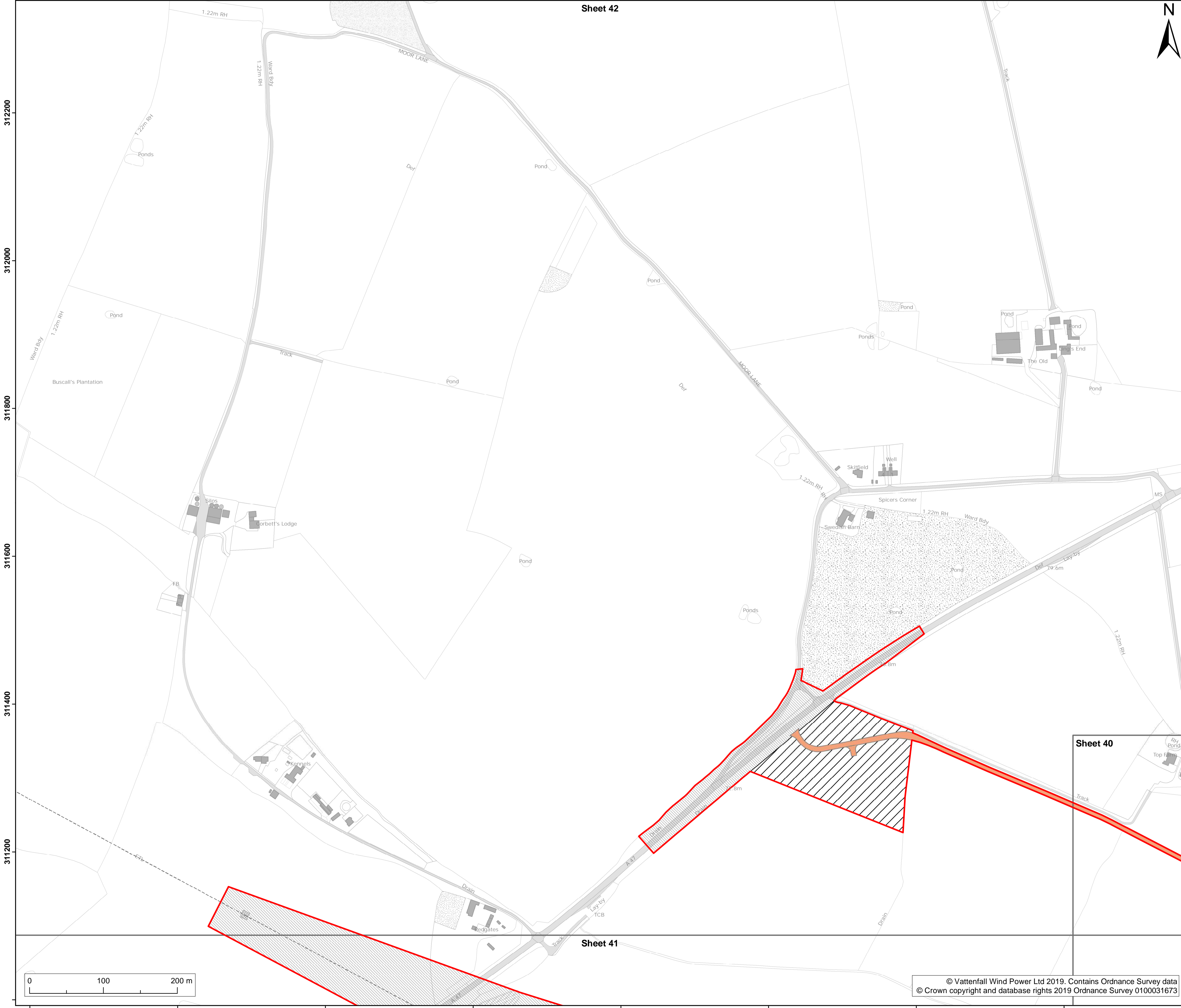

- Legend:**
- Order limits
 - Sheet boundary
 - Alternate area only to be used under Scenario 2
 - Land to be used in connection with construction or maintenance of the works
 - Mobilisation zone
 - Site side access

Project: **Norfolk Boreas Offshore Wind Farm** Report: **Development Consent Order**

Title: **2.4 Works plan (onshore) (sheet 42a of 42 - Scenario 1)**

Doc Ref: 2.4	APFP Ref: 5(2)(j)	Drawing No: PB5640-007-000-006			
Revision: 03	Date: 19/20/2019	Drawn: LB	Checked: CD	Size: A1	Scale: 1:2,500
02	02/01/2019	LB	CD	A1	1:2,500

Co-ordinate system: British National Grid EPSG: 27700

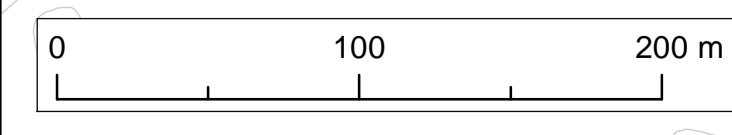

© Vattenfall Wind Power Ltd 2019. Contains Ordnance Survey data © Crown copyright and database rights 2019 Ordnance Survey 0100031673



588200 588400 588600 588800 589000 589200 589400 589600

311000

588200 588400 588600 588800 589000 589200 589400 589600

Sheet 42

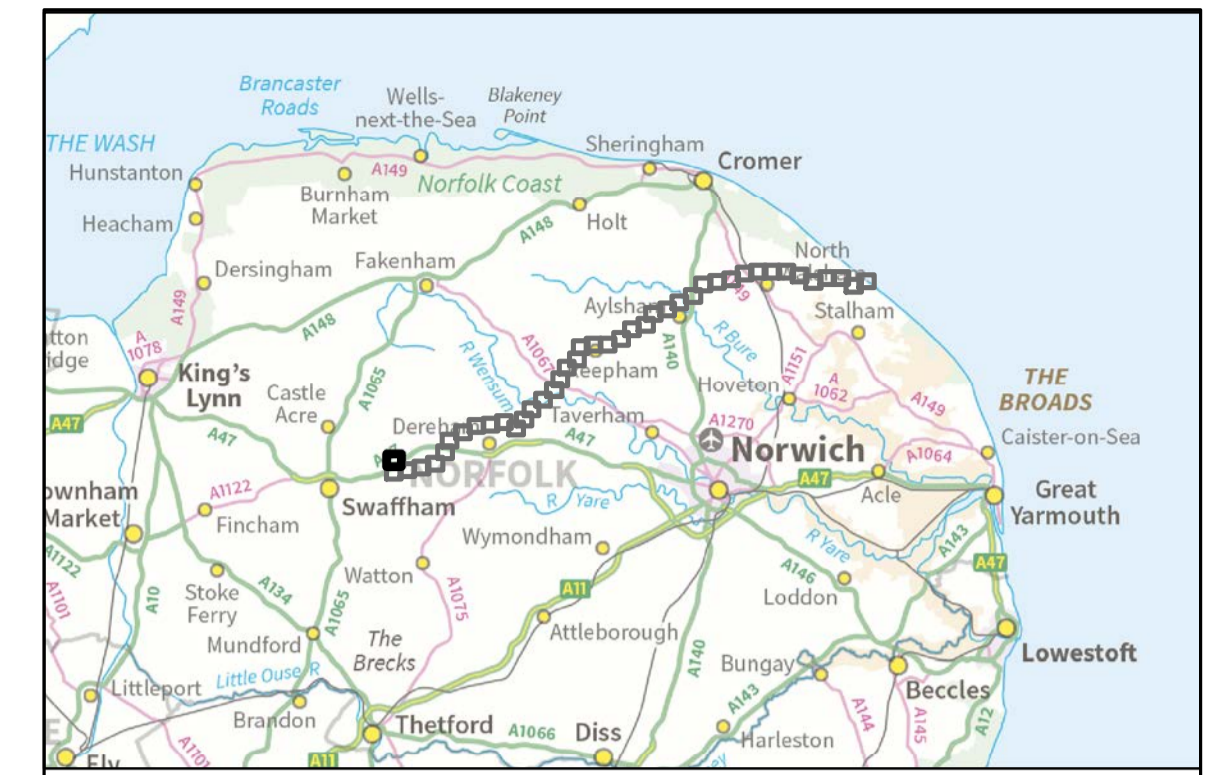

- Legend:**
- Order limits
 - Sheet boundary
 - Work No. 10C
 - Work No. 12B
- Land to be used in connection with construction or maintenance of the works**
- Mobilisation zone
 - National Grid overhead line temporary works area and overhead line modification corridor
 - Site side access
 - Street subject to street works (streets)
 - Points referred to in Schedule 2 of the DCO

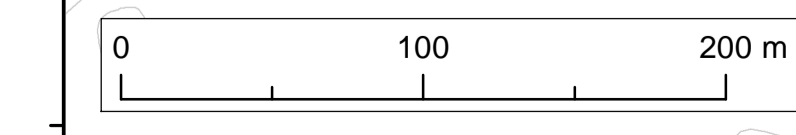

© Vattenfall Wind Power Ltd 2019. Contains Ordnance Survey data
© Crown copyright and database rights 2019 Ordnance Survey 0100031673

Project: **Norfolk Boreas Offshore Wind Farm** Report: **Development Consent Order**

Title: **2.4 Works plan (onshore) (sheet 42b of 42 - Scenario 2)**

Doc Ref: 2.4	APFP Ref: 5(2)(j)	Drawing No: PB5640-007-000-010			
Revision: 03	Date: 19/02/2019	Drawn: LB	Checked: CD	Size: A1	Scale: 1:2,500
Revision: 02	Date: 02/01/2019	Drawn: LB	Checked: CD	Size: A1	Scale: 1:2,500

Co-ordinate system: British National Grid EPSG: 27700



588200 588400 588600 588800 589000 589200 589400 589600

311000